

Inductive Proximity Sensors (DC Cylindric Sizes)

ID2LI0812

M8 (NPN NO)

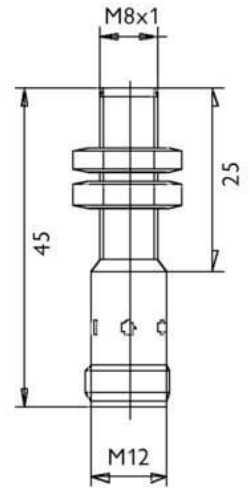

Connection:	plug M12
Connection type:	plug M12
Outlet:	NPN NO
Design:	M8
Diameter:	M8x1
Installation type:	flush
Short protection:	yes
Length:	45 mm
LED:	yes
No-load current:	15 mA
Nominal voltage:	24 VDC
Reproducibility:	1 %
Switching distance:	2 mm
Switching frequency:	5000 Hz
Switching hysteresis:	15 %
Protection class:	IP 65
Voltage drop:	2 V
Voltage type:	VDC
Voltage range:	10 - 30 V
Ampacity:	200 mA
Temperature drift:	10 °C
Environment temperature:	-25 bis 70 °C
Material:	nickel plated brass

Further information about this product can be found on our website, please visit:

https://schoenbuch-sensor.de/en/products/id2li0814_en/id2li0812_en/