

Inductive Proximity Sensors (DC Cylindric Sizes)

# IB1,5DA0415

## 4 (PNP NC)

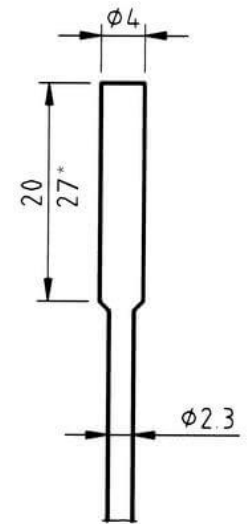

Connection:	2 m PUR/3 x 0,14 mm <sup>2</sup>
Connection type:	cable
Outlet:	PNP NC
Design:	4
Diameter:	4
Installation type:	flush
Short protection:	yes
Length:	27 mm
LED:	yes
No-load current:	10 mA
Nominal voltage:	24 VDC
Reproducibility:	1 %
Switching distance:	1,5 mm
Switching frequency:	1000 Hz
Switching hysteresis:	15 %
Protection class:	IP 67
Voltage drop:	1,5 V
Voltage type:	VDC
Voltage range:	10 - 35 V
Ampacity:	150 mA
Temperature drift:	10 °C
Environment temperature:	-25 bis 70 °C
Material:	stainless steel

Further information about this product can be found on our website, please visit:

[https://schoenbuch-sensor.de/en/products/ib15da0415\\_en/](https://schoenbuch-sensor.de/en/products/ib15da0415_en/)