

Inductive Proximity Sensors (DC NAMUR)

ICBA6508

6.5 (namur output)

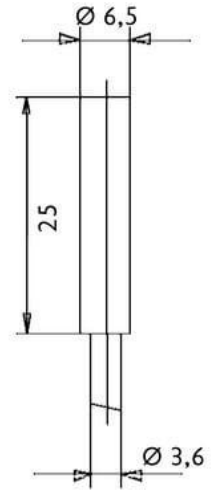

Connection:	2 m/2 x 0,14 mm ²
Connection type:	cable
Outlet:	Namur Ausgang
Design:	6.5
Diameter:	6.5
Installation type:	flush
Length:	25 mm
Reproducibility:	0,01 mm
Switching distance:	1,5 mm
Switching frequency:	5000 Hz
Protection class:	IP 67
Voltage type:	VDC
Voltage range:	7,7 - 9 V
Temperature drift:	10 °C
Environment temperature:	-25 bis 70 °C
Material:	nickel plated brass

Further information about this product can be found on our website, please visit:

https://schoenbuch-sensor.de/en/products/icba6508_en/