

Inductive Proximity Sensors (DC Cylindric Sizes)

# IDDA6513

## 6.5 (NPN NC)

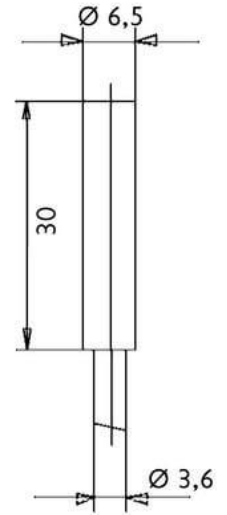

|                          |                                  |
|--------------------------|----------------------------------|
| Connection:              | 2 m PVC/3 x 0,14 mm <sup>2</sup> |
| Connection type:         | cable                            |
| Outlet:                  | NPN NC                           |
| Design:                  | 6.5                              |
| Diameter:                | 6.5                              |
| Installation type:       | flush                            |
| Short protection:        | yes                              |
| Length:                  | 30 mm                            |
| LED:                     | yes                              |
| No-load current:         | 15 mA                            |
| Nominal voltage:         | 24 VDC                           |
| Reproducibility:         | 1 %                              |
| Switching distance:      | 1,5 mm                           |
| Switching frequency:     | 5000 Hz                          |
| Switching hysteresis:    | 15 %                             |
| Protection class:        | IP 67                            |
| Voltage drop:            | 2 V                              |
| Voltage type:            | VDC                              |
| Voltage range:           | 10 - 30 V                        |
| Ampacity:                | 200 mA                           |
| Temperature drift:       | 10 °C                            |
| Environment temperature: | -25 bis 70 °C                    |
| Material:                | nickel plated brass              |

Further information about this product can be found on our website, please visit:

[https://schoenbuch-sensor.de/en/products/idda6514\\_en/idda6513\\_en/](https://schoenbuch-sensor.de/en/products/idda6514_en/idda6513_en/)