



PROFIBUS Receptacle Connectors

FWD 5B



M12 Male to Female

Receptacle connector, combined M12 male connector to combined M12 female connector.

– especially designed for use as panel feed through –

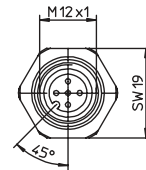
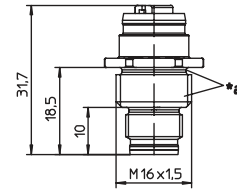

Pin Assignment

M12 - 5 Poles (B-Coding)

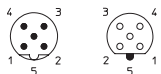



Be Certain with Belden

PROFIBUS Receptacle Connectors

FWD 5B

Technical Data

Environmental

Degree of protection IP 67 / NEMA 6P
 Operating temperature range -25°C (-13°F) / +80°C (+176°F)

Mechanical

Housing / Molded body CuZn, nickel-plated
 Insert Male connector PA 6.6
 Insert Female connector TPU, self-extinguishing
 Contact CuZn, pre-nickeled and 0.8 microns gold-plated
 O-ring FKM

Electrical

Contact resistance ≤ 5 mΩ
 Nominal current at 40°C 4 A
 Nominal voltage 60 V
 Test voltage 1.5 kV eff. / 60 s
 Insulation resistance > 10⁹ Ω
 Pollution degree 3

Part Number	Pins
-------------	------

FWD 5B

5B