



D-SUB / M12 Connectors for Profibus

0976 PMC 512 | 0976 PMC 514



9-Pole (D-Sub) 35° Compact Version

Profibus connector, 35° compact version, M12 B-coding, male and female quick connector, full metal body with testing socket, with external switch for bus termination.

0976 PMC 512

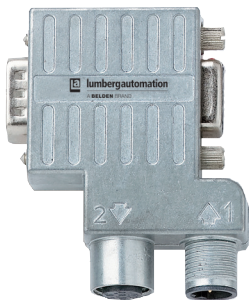
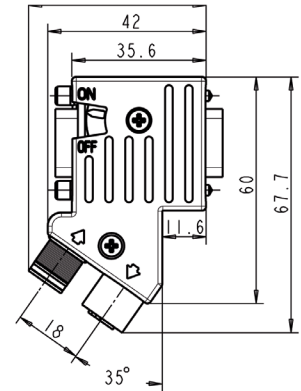
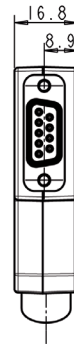
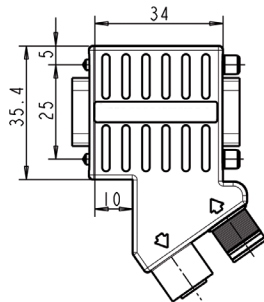

9-Pole (D-Sub) 90° Compact Version

Profibus connector, 90° compact version, M12 B-coding, male and female quick connector, full metal body with testing socket, with external switch for bus termination.

0976 PMC 514

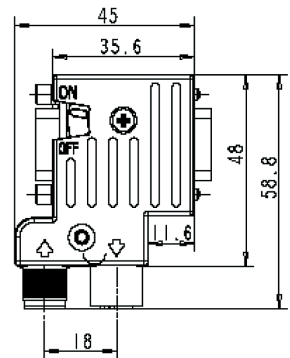
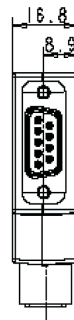
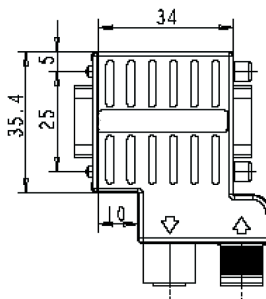



Be Certain with Belden

D-SUB / M12 Connectors for Profibus

0976 PMC 512 | 0976 PMC 514

Technical Data

| | |
|------------------------------------|--|
| Data Rate | 12 MBit/s |
| Environmental | |
| Degree of protection | IP 30 |
| Operating temperature range | -20°C (-4°F) / +70°C (+158°F) |
| Permissible humidity | Max 75% at +25°C, non-condensing |
| Mechanical | |
| Housing / Molded body | Zn alloy |
| D-Sub locking screw | UNC 4-40 |
| Connector and pin layout | acc. to PROFIBUS specification |
| Dimensions in mm | 0976 PMC 512: 67.7 x 45 x 16.8 0976 PMC 514: 58.8 x 45 x 16.8 |
| Mechanical Lifetime | 200 Mating cycles |
| Interfaces | |
| PROFIBUS DP | D-Sub 9 poles male |
| PROFIBUS DP PG | D-Sub 9 poles female |
| PROFIBUS cable | M12 B-code male and female, Pin 1 = +5V Pin 2 = Line A Pin 3 = GND (0V) Pin 4 = Line B |
| Shielded Profibus M12-Cable | B-Code: only Pin 2 and 4 connected, shield transfer only via shell (e.g. 0975 254 10x/... M) |
| Bus Termination | Bus termination resistors activated via external switch or via external terminator on Bus-Out-Connector (e.g. 0979 PTX 101) |

| Part Number | Pins D-Sub | Pins M12 |
|--------------|------------|----------|
| 0976 PMC 512 | 9 | 5 B |
| 0976 PMC 514 | 9 | 5 B |