



## PROFIBUS Receptacle Connectors

0976 PMC 152



### M12 Male

Receptacle connector, M12 male connector for front mounting, 5 poles, B coding, print contacts, chassis side thread PG 9.

– especially suitable for Profibus –

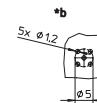
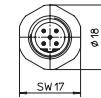
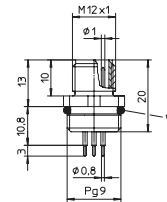

\*a O-Ring

\*b hole pattern in printed circuit board

0976 PFC 152



### M12 Female

Receptacle connector, M12 female connector for front mounting, 5 poles, B coding, printed contacts, chassis side thread PG 9.

– especially suitable for Profibus –

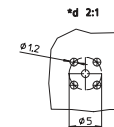
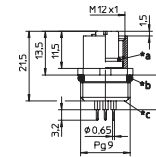

\*a O-Ring

\*b O-ring loose enclosed

\*c solder contacts potted with epoxy

\*d hole pattern in printed circuit board

## Pin Assignment

M12 - 5 Poles (B-Coding)

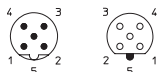



Be Certain with Belden

**PROFIBUS Receptacle Connectors**

0976 PMC 152 | 0976 PFC 152

**Technical Data**

**Environmental**

Degree of protection IP 67 / NEMA 6P  
 Operating temperature range -25°C (-13°F) / +90°C (+194°F)

**Mechanical**

Housing / Molded body CuZn, nickel-plated  
 Insert TPU, self-extinguishing  
 Contact CuZn, pre-nickeled and 0.8 microns gold-plated  
 O-ring FKM  
 Mode of connection printed circuit board mount

**Electrical**

Contact resistance ≤ 5 mΩ  
 Nominal current at 40°C 4 A  
 Nominal voltage 60 V  
 Rated voltage 63 V  
 Test voltage 1.5 kV eff. / 60 s  
 Insulation resistance > 10<sup>9</sup> Ω  
 Pollution degree 3

Part Number	Pins	
0976 PMC 152	5B	 
0976 PFC 152	5B	 