

**0911 ANC 101**

**AS-Interface Junction Branches**

AS-Interface branch to connect AS-Interface slaves via a M12 connector with a flat cable system.

**Technical Data**

<b>Environmental</b>	
Degree of protection	IP 65
Housing material	PA
Nominal current at 40°C	4 A

**Note**

- insertion of the AS-Interface flat cable (yellow) in cable shaft "LINE1"
- insertion of the additional voltage supply (black flat cable) in cable shaft "LINE 2"

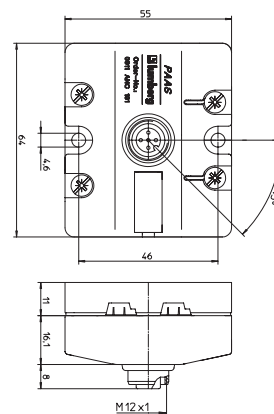
**0911 ANC 401**



AS-Interface branch to connect two flat cables (opening of an AS-Interface branch or additional voltage supply).

**Technical Data**

<b>Environmental</b>	
Degree of protection	IP 65
Housing material	PA
Nominal current at 40°C	8 A

**Note**

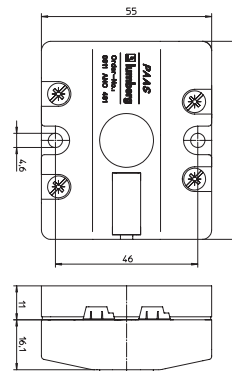
Please be aware that only two wires with the same function may be inserted into this AS-Interface branch. This means that either only the yellow or only the black AS-Interface flat cable may be used.

**Pin Assignments**
**Cable M12 - 5 Poles**

1 = AS-Interface +	brown
2 = 0 V AUX	white
3 = AS-Interface -	blue
4 = +24 V AUX	black
5 = earth	green/yellow



1 = AS-Interface +
2 = 0 V AUX
3 = AS-Interface -
4 = +24 V AUX
5 = earth

**Part Number**

0911 ANC 101

0911 ANC 401



The application of these products in harsh environments should always be checked before use. Specifications subject to alteration.